

ANNEXURE C – PRELIMINARY LOT LAYOUT

"The Glades"

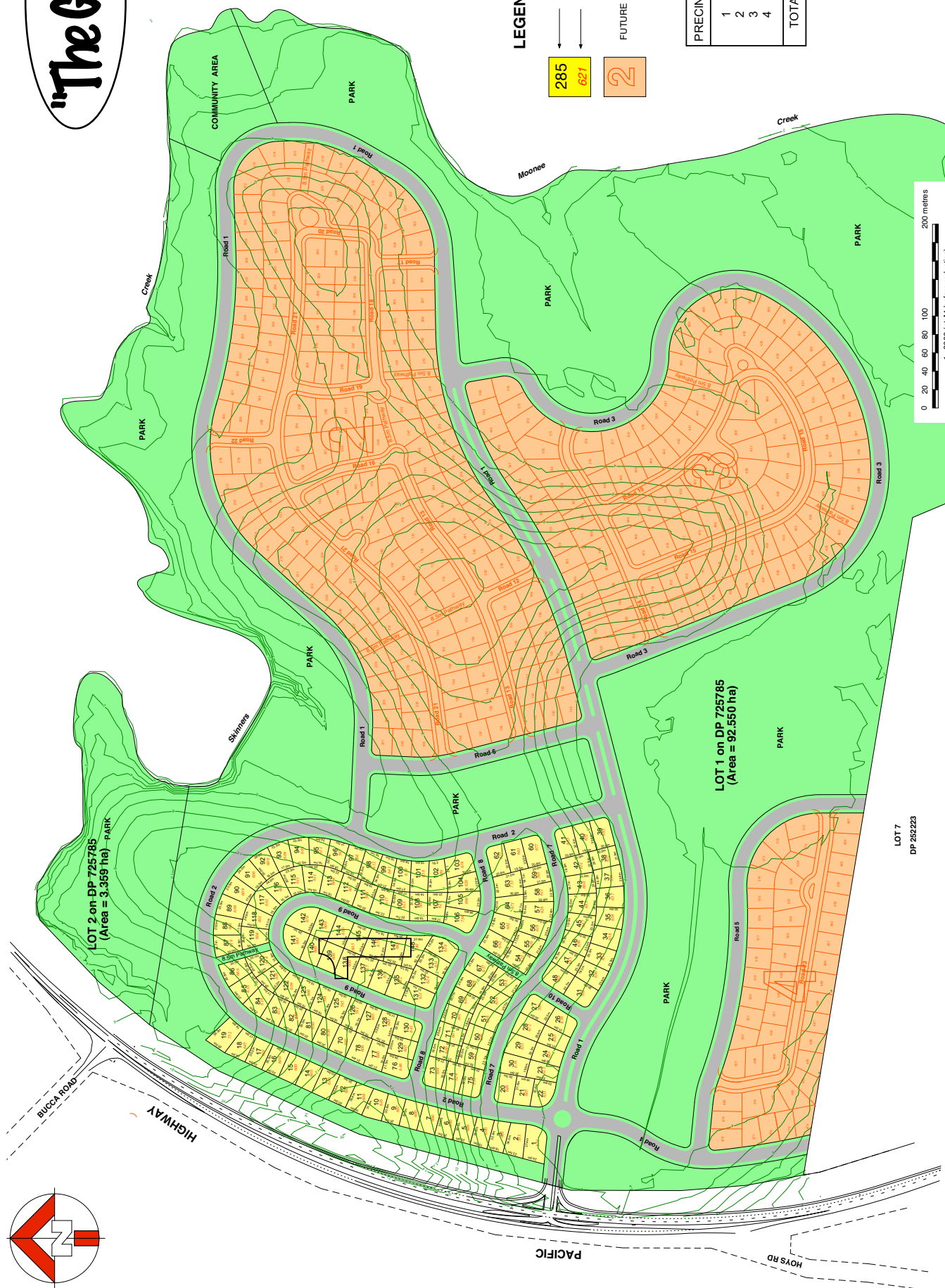

LEGEND

- ← LOT NUMBER
- ← LOT AREA
- 2 FUTURE RESIDENTIAL AREA

| PRECINCT | No. OF LOTS |
|----------|-------------|
| 1 | 148 |
| 2 | 194 |
| 3 | 131 |
| 4 | 50 |
| TOTAL | 523 |

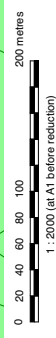

LOT 2 on DP 725785
(Area = 3.359 ha) - PARK

LOT 1 on DP 725785
(Area = 92.550 ha)

LOT 7
DP 252223

| | | | | | | | |
|-------------------------------|--|---|--|--|--|--|--|
| | | AUSPACIFIC ENGINEERS PTY LTD development consultants, civil, structural and hydraulic engineers | | THE ROTHWELL BOYS PTY LTD | | 04-1600 | |
| | | 3 / 20 Nerang Street NERANG QLD 4211 T 07 5596 5377 F 07 5596 3443 E auspacific@auspacific.com.au | | AS SHOWN drawn JM checked RKH signed JM | | project PROPOSED RESIDENTIAL SUBDIVISION MOONEE BEACH COFFS HARBOUR | |
| PRELIMINARY LOT LAYOUT | | <small>DISCLAIMER: This is a preliminary concept plan prepared by Auspacific. The concept plan has been prepared by the Consultant for the benefit of the client and is not to be used for any other purpose. The consultant does not warrant the accuracy of the information provided in this concept plan and is not responsible for any errors or omissions. The client is advised to seek independent professional advice before relying on this concept plan. No third party is entitled to rely upon the information contained in this preliminary report and any definitive advice as to budgets, yields, etc., should be sought directly from the consultant.</small> | | drawing no. P1 amendment B | | drawing no. P1 amendment B | |